

# Family datasheet

## Square ECO



### Product description

Square ECO is a 595x595 mm LED panel with state-of-the-art LED technology and LED source with 50,000 hours lifetime. Color temperature 4000K with CRI 80+ and luminous flux 4080 lm. Steel body with PMMA diffuser for optimal light distribution and DALI control option available. Fully compatible with existing lighting infrastructure. Ideal for offices, halls and commercial spaces. 5-year warranty.

LED 220-240 V 50-60 Hz IP20   UGR < 19

### Technical description

Mains voltage	220 - 240V AC, 50/60Hz
Connection method	Plug-in terminal
IP rating	20
Protection class	II
Light source	LED
Switching type	Non-dimmable , DALI
CRI	80
CCT	4000K
Lumen output	4080 lm
Efficiency	Up to 120 lm/W
Power consumption	34 W

Optical system	Diffuser
Optical part material	PMMA
Housing material	Steel
Surface finish	Powder coated
Ambient temperature	0 to +30°C
Service lifetime (L80 B10)	50 000h
Warranty	5 years

### Dimensions

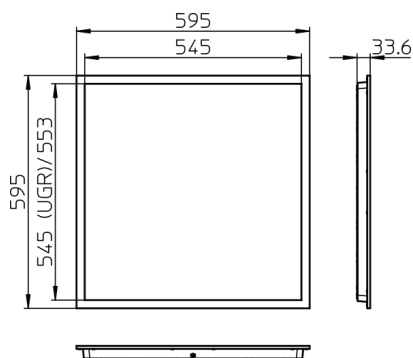

### Light distribution curves

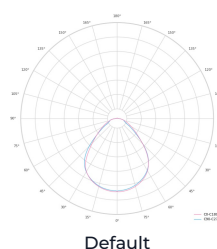

## Product codes

The technical specifications of the luminaire are determined through the combination of these attributes, which result in a unique product code.

Order code example: **SQECO-59-840-1**

Attribute	Value	Code
Model	Square ECO	SQECO-
Version	595x595	59
CCT	4000k (CRI 80+)	840
Dimming	Non-dimmable	1
	DALI	2

## Optional products



Square Easy  
frame

Square  
suspension kit